

# \$550,000 - 14732 91 Avenue, Edmonton

MLS® #E4444391

**\$550,000**

2 Bedroom, 2.00 Bathroom, 1,113 sqft  
Single Family on 0.00 Acres

Parkview, Edmonton, AB

Opportunity knocks in Parkview! This 56' x 110' lot offers endless potential in one of Edmonton's most desirable neighbourhoods. Whether you're looking to renovate the existing bungalow or start fresh with a custom-built home, this prime location is ideal. Surrounded by mature trees and nestled on a quiet street with both a back yard and back and side lane access, this property is perfect for investors, builders, or anyone ready to create something remarkable. Enjoy walking distance to top-rated schools, local shops, cafes, and the River Valley trail system. Parkview is known for its family-friendly charm, strong community vibe, and easy access to downtown, making it one of the most sought-after areas in the city. Don't miss your chance to secure a foothold in this prestigious west Edmonton community. Explore the possibilities today and unlock the value of this rare find!

Built in 1954

## Essential Information

|            |           |
|------------|-----------|
| MLS® #     | E4444391  |
| Price      | \$550,000 |
| Bedrooms   | 2         |
| Bathrooms  | 2.00      |
| Full Baths | 2         |

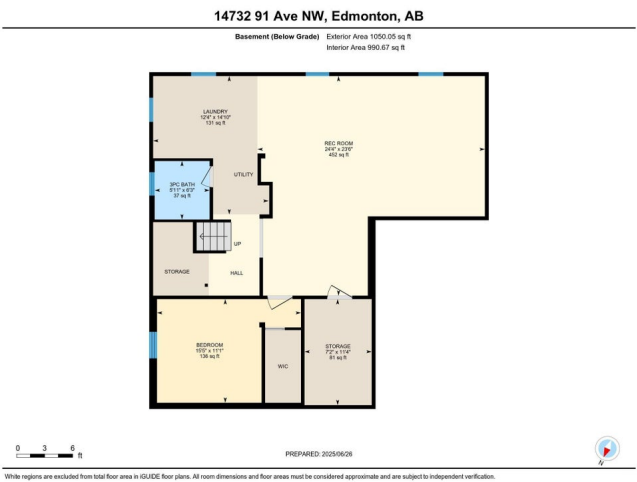

|                |                        |
|----------------|------------------------|
| Square Footage | 1,113                  |
| Acres          | 0.00                   |
| Year Built     | 1954                   |
| Type           | Single Family          |
| Sub-Type       | Detached Single Family |
| Style          | Bungalow               |
| Status         | Active                 |

### Community Information

|             |                 |
|-------------|-----------------|
| Address     | 14732 91 Avenue |
| Area        | Edmonton        |
| Subdivision | Parkview        |
| City        | Edmonton        |
| County      | ALBERTA         |
| Province    | AB              |
| Postal Code | T5R 4Z1         |

### Amenities

|                |                        |
|----------------|------------------------|
| Amenities      | Deck, Detectors Smoke  |
| Parking Spaces | 3                      |
| Parking        | Single Garage Detached |

### Interior

|              |   |
|--------------|---|
| Appliances   | Dishwasher-Built-In, Dryer, Freezer, Refrigerator, Stove-Electric, Washer, Window Coverings |
| Heating      | Forced Air-1, Natural Gas   |
| Stories      | 2   |
| Has Basement | Yes   |
| Basement     | Full, Partially Finished  |

### Exterior

|                   |  |
|-------------------|--|
| Exterior          | Wood, Metal  |
| Exterior Features | Back Lane, Fenced, Fruit Trees/Shrubs, Paved Lane, Playground Nearby, Schools, Shopping Nearby |
| Lot Description   | 56 ft x 110 ft   |
| Roof              | Asphalt Shingles   |
| Construction      | Wood, Metal  |
| Foundation        | Concrete Perimeter   |

### Additional Information

Date Listed June 26th, 2025

Days on Market 21

Zoning Zone 10

DATA IS DEEMED RELIABLE BUT IS NOT GUARANTEED ACCURATE BY THE REALTORS® ASSOCIATION OF EDMONTON. COPYRIGHT 2025 BY THE REALTORS® ASSOCIATION OF EDMONTON. ALL RIGHTS RESERVED. Trademarks are owned or controlled by the Canadian Real Estate Association (CREA) and identify real estate professionals who are members of CREA (REALTOR®, REALTORS®) and/or the quality of services they provide (MLS®, Multiple Listing Service®)

Listing information last updated on July 17th, 2025 at 9:47am MDT